

NDA-16 DAVIT
 SWL HOISTING: 1650 kg
 SWL LOWERING: 1650 kg
 HOISTING SPEED: MINIMUM 18 M/MIN
 LOWERING SPEED: MINIMUM 18 M/MIN
 DESIGN SPEC: 10° TRIM, 20° LIST SIMULTANOUSLY
 DEAD SHIP LOWERING SPEED: MAXIMUM 60 M/MIN
 DAVIT WEIGHT: 1400 kg

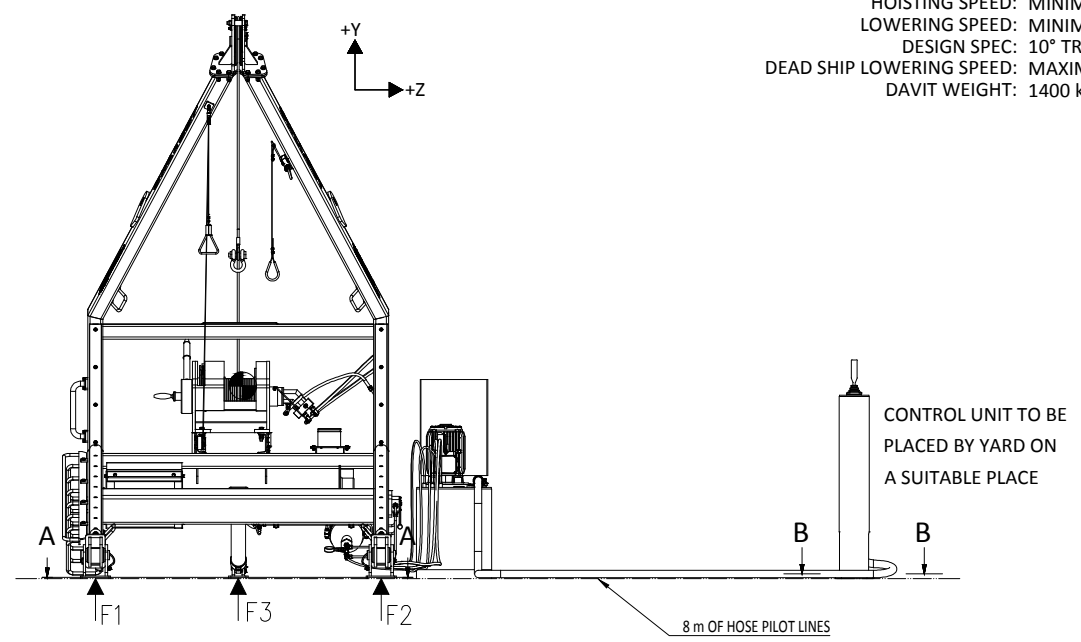
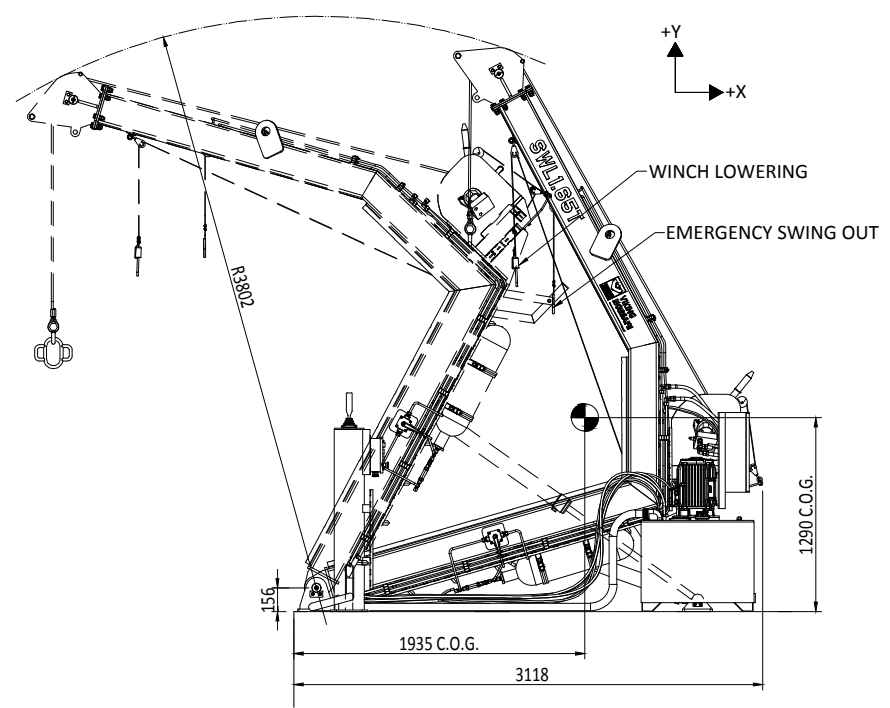

- NOTES:**
- EMBARKATION PLATFORMS, LADDERS ETC.: YARD SUPPLY.
 - LOCATION OF HYDRAULIC POWER UNIT TO BE DECIDED BY YARD.
 - NORSAFE DELIVER 4m HOSES FOR CONNECTION BETWEEN DAVIT AND HPU. HYDRAULIC PIPING BETWEEN HPU AND DAVIT IS YARD SUPPLY.
 - CONNECTION OF MAIN POWER SUPPLY TO EL. CABINET IS YARD SUPPLY.
 - ALL FIELD WELDS TO BE PERFORMED ACC. TO APPROVED WPS. (YARD RESPONSIBILITY). ALL FIELD WELDING IS SUBJECT TO CLASS APPROVAL PRIOR TO START WELDING.
 - FOR WINTERIZATION / ARCTIC AREAS OPERATION STEEL TO BE WITH CHARPY TESTING AT -20 DEGREES. HPU TO BE EQUIPPED WITH OIL SUMP HEATER.

FORCES IN DECK (POINT LOAD EACH SIDE):
 FOR ORIENTATION OF FORCES, SEE LEGEND ON DRAWING

NDA-16 Davit Reaction Forces in Deck							
Nodes	Force			Moment			
	Fx (kN)	Fy (kN)	Fz (kN)	Mx (kNm)	My (kNm)	Mz (kNm)	
F1 / F2	MAX.	36	28	3	3	2	2
	MIN.	-11	-3	-6	-4	-1	-6
F3	MAX.	28	27	0	0	0	6
	MIN.	-76	-17	0	0	0	-2

ALL FORCES ARE NOMINAL FORCES WITHOUT ANY SAFETY FACTORS.
 ALL FOUNDATIONS SHALL BE DESIGNED WITH A FACTOR OF SAFETY OF MINIMUM 4,5.

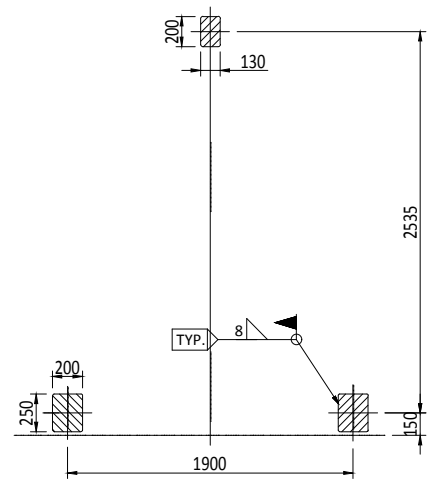

A-A (1:25)
INTERFACE FOOT PRINTS IN DECK

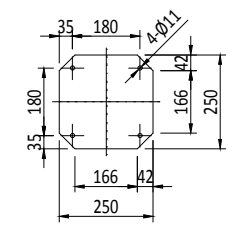

B-B (1:10)
FOOT PRINT

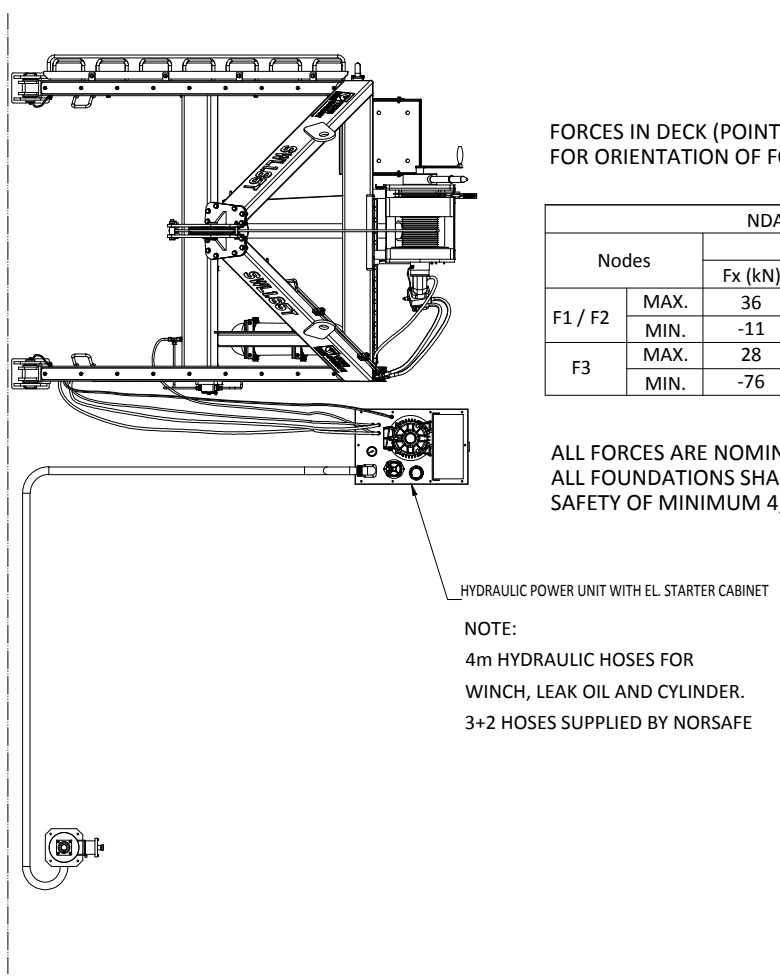

HYDRAULIC POWER UNIT WITH EL. STARTER CABINET

NOTE:
 4m HYDRAULIC HOSES FOR WINCH, LEAK OIL AND CYLINDER.
 3+2 HOSES SUPPLIED BY NORSAFE

1	Re-issued for approval	CENI	GACA	WAGU	17.06.2019
0	Issued for construction	GACA	ALJI	WAGU	18.04.2014
REV	DESCRIPTION	BY	CHECK	APPRO	DATE

REVISION HISTORY

VIKING NORSAFE

VIKING Norsafe Life-Saving Equipment Norway AS
 P.O. Box 115
 4852 Færevik
 NORWAY
 Tel: +47 37 05 85 00
 Fax: +47 37 05 85 01
 24/7 Service: +47 37 05 63 33
 Email: viking@viking-life.com

This drawing is the sole property of VIKING Norsafe Life-Saving Equipment Norway AS. It must not be submitted to other parties nor used in any manner detrimental to our interests. It shall not be copied, reproduced, used for manufacturing or sale without the written consent of VIKING Norsafe Life-Saving Equipment Norway AS. All rights are reserved.

DWG SIZE: A3	SCALE: 1:50	COPY OF:	PART NO.	WEIGHT:	SHEET: 1/1
CLIENT NO:	PROJECTION METHOD:	NDA-16 Rescue Boat Davit			
TOLERANCES: ISO 2768-mk, ISO 13920-BF	REVISION: 1	General Arrangement			
DWG No: G-500292	PROJECT:				