

The Max. height means the distance from profile steel of center beam to the upside of platform

E-60 DAVIT

SWL HOISTING (MANUAL/ELECTRIC): 4000kg
 SWL LOWERING: 6000kg
 HOISTING SPEED OF LIFE TYPE: APPROX 5 m/min
 HOISTING SPEED OF RESCUE TYPE: APPROX 18 m/min
 DESIGN SPEC SOLAS: 10° TRIM, 20° LIST SIMULTANEOUSLY
 DEAD SHIP LOWERING SPEED: MAXIMUM 60 m/min
 DAVIT WEIGHT APPR. 3483KG INCLUDE DW34H WINCH

2	Updated the drawing name	MISO	ALJI	WAGU	14.10.2020
1	Updated for approval	MISO	ALJI	WAGU	22.11.2019
REV	REASON FOR ISSUE	BY	CHECK	APPRO	DATE

REVISION HISTORY



VIKING NORSAFE

VIKING Norsafe Life-Saving Equipment Norway AS
 P.O Box 115 Tel: +47 37 05 85 00
 4852 Færвик Fax: +47 37 05 85 01
 NORWAY 24/7 Service: +47 37 05 63 33
 Email: Viking-Norsafe@viking-life.com

Drawn by	Check by	Appr. by	Initial release date
TOWU	MISO	WAGU	22.11.2019

Project number	Project name	Client number
----------------	--------------	---------------

Title	Material Number
-------	-----------------

E-60 DAVIT FOR JYN-65, PS

Weight
4263.9 kg

Projection method

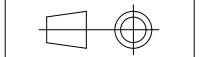

Drawing type	Tolerances	Scale	Sheet Size
GA	ISO 2768-mK, ISO 13920-BF	1:50	A3
Drawing Number	Revision	Sheet No.	
G-503166	2	1/2	

- NOTES:
- ACCESS PLATFORMS & BOARDING, WALK WAYS, STAIRS & HANDRAILINGS, DOUBLER PLATES, ETC.: YARD SUPPLY - TO BE FINALIZED DURING LIFEBOAT INSTALLATION.
 - ELECTRIC WIRING BY YARD.
 - FIELD WELDS TO BE WELDED BY YARD ARE SHOWN BY FLAG:
 - ALL FIELD WELDS TO BE PERFORMED ACC. TO APPROVED WPS. (YARD RESPONSIBILITY). ALL FIELD WELDING IS SUBJECT TO CLASS APPROVAL PRIOR TO START WELDING.
 - ALL STRUCTURAL STEEL TO BE S355, Q345D, S235 AND Q235. OUTFITTING STEEL TO BE S235, Q235 OR EQUIVALENT.
 - WIRE LENGTHS: MAIN WIRE AFT - $\Phi 16 : 14 \text{ m} + 2 \times (H + H1)$
 MAIN WIRE FWD - $\Phi 16 : 17 \text{ m} + 2 \times (H + H1)$
 REMOTE CONTROL WIRE: DECK REMOTE CONTROL WIRE - $\Phi 3 : 11 \text{ m}$
 BOAT REMOTE CONTROL WIRE - $\Phi 3 : 13 \text{ m} + (H + H1)$
 H= HEIGHT FROM STOWAGE TO L.W.L.
 H1= ADDITIONAL HEIGHT DUE TO LIST AND TRIM CONDITIONS, UNLESS OTHERWISE AGREED.
 - FOR LOCATION OF HATCHES, HOOKS AND OTHER BOAT DETAILS SEE BOAT DRAWINGS.
 - C.O.G. SHOWN NOT INCLUDE LIFEBOAT, FOR DAVIT ONLY.

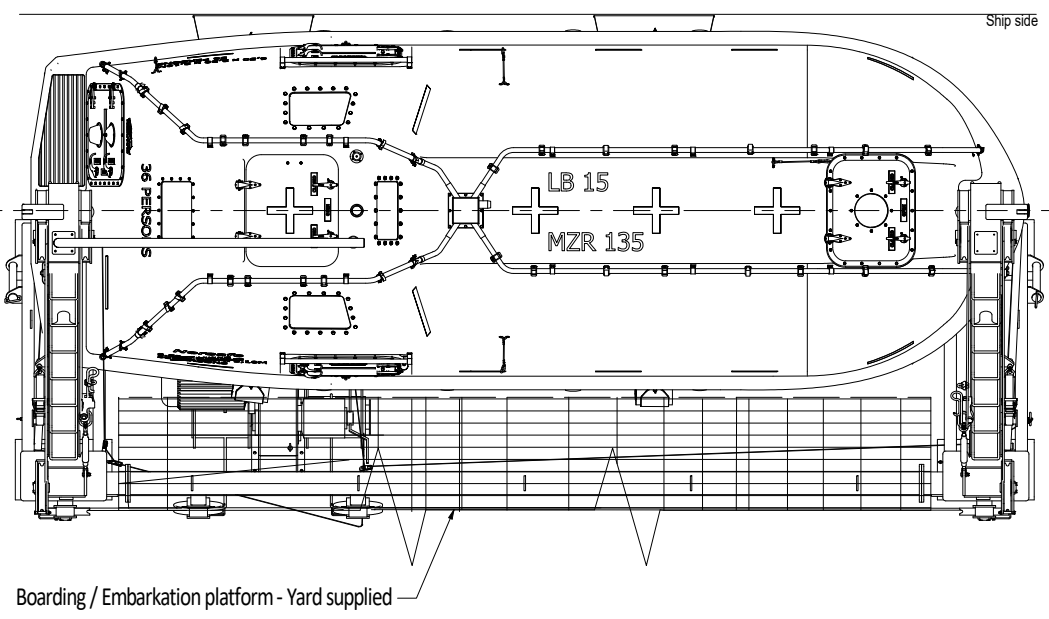

Boarding / Embarkation platform - Yard supplied

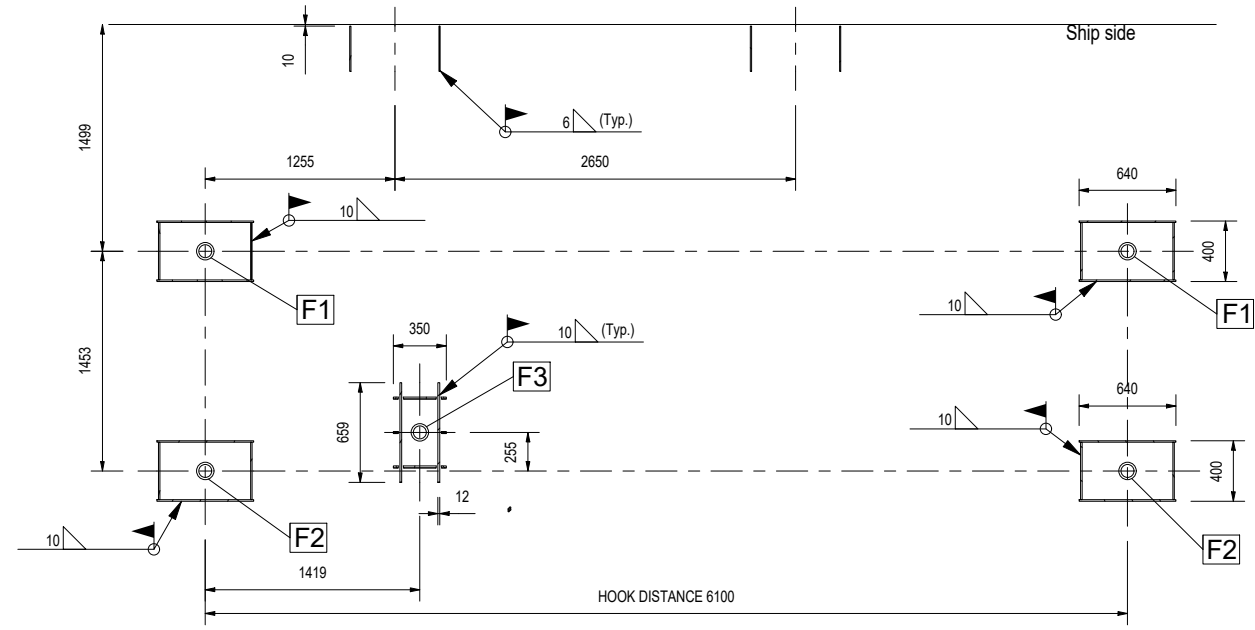
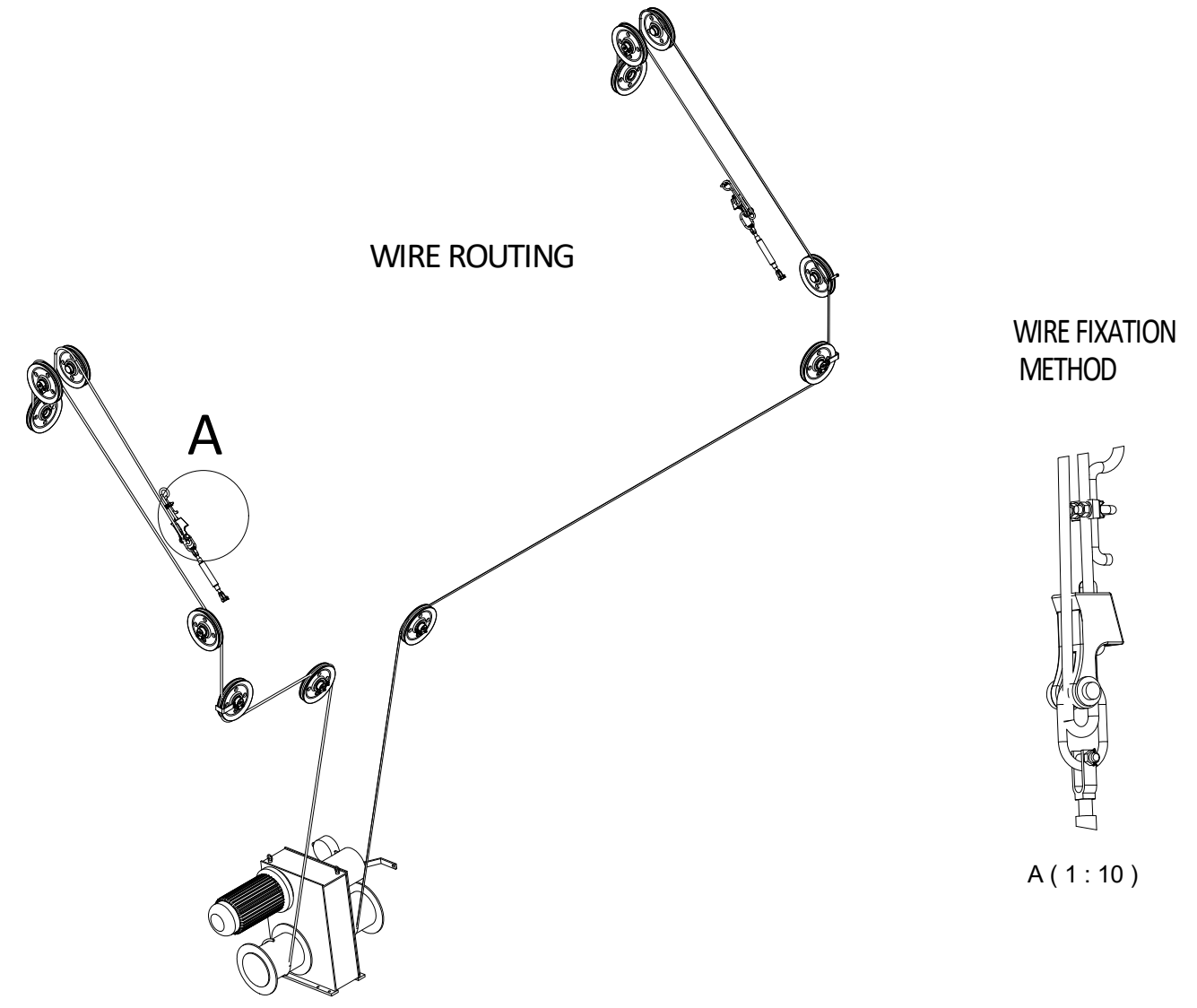
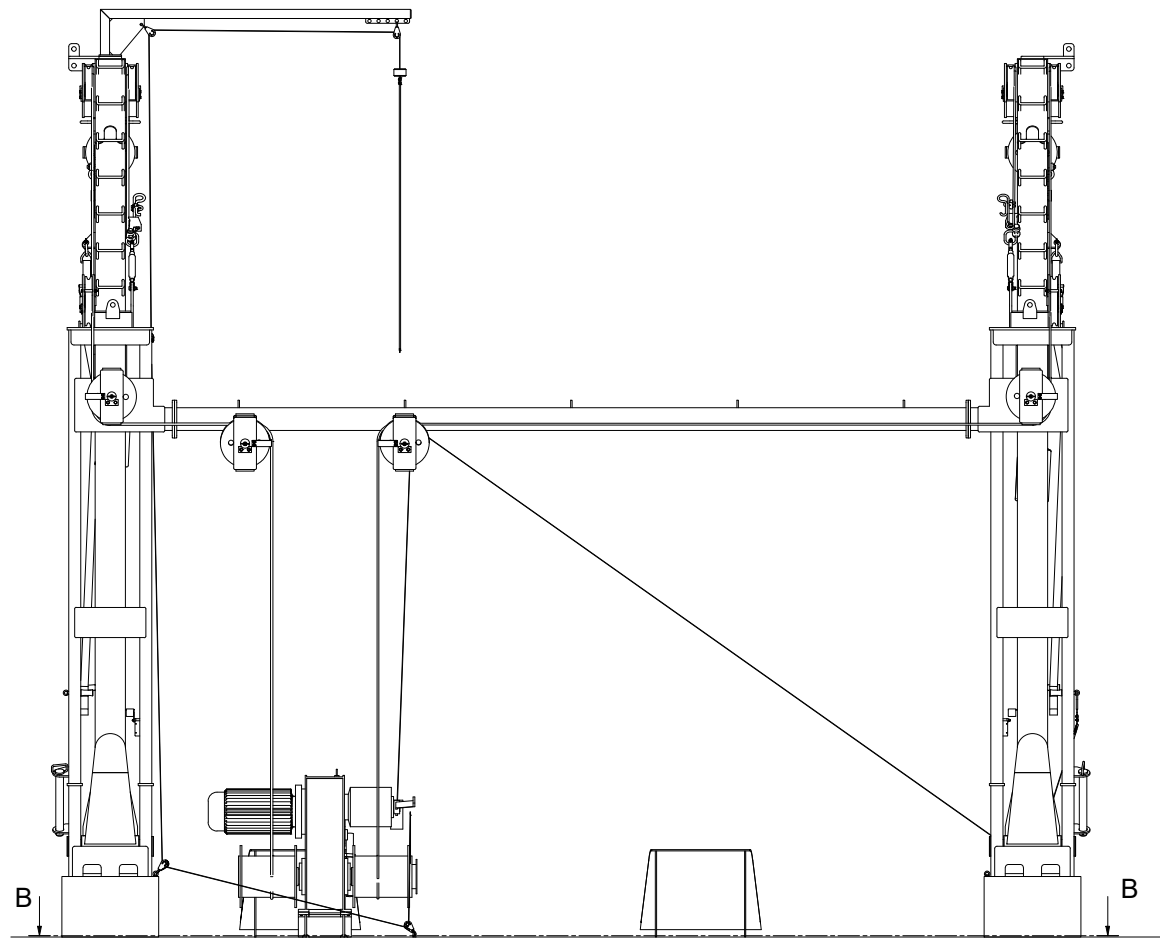

NOTES:
 1. IN CASE OF VESSELS CHAMBER DECK FOUNDATIONS ARE YARD SUPPLIED.
 2. REACTION FORCES AS JOINT LOADS EACH SIDE, MARKED WITH NODES ON DECK INTERFACE.
 FOR ORIENTATION OF FORCES SEE LEGEND WITH MARKED XYZ VECTORS.
 ALL FORCES ARE POINT LOADS, NOMINAL FORCES WITHOUT ANY FACTORS.

JOINT LOADS ON EACH SIDE (FOR ORIENTATION OF FORCES SEE LEGEND)
 REACTIONS FOR DIFFERENT COMBINATION OF 20° LIST & 10° TRIM

	FORCE X	FORCE Y	FORCE Z	MOM X	MOM Y	MOM Z
F1	-12KN	152KN	46KN	-14KNm	10KNm	23KNm
F2	-9KN	-97KN	-47KN	-34KNm	7KNm	46KNm
F3	0	-30KN	0	0	0	0

		VIKING Norsafe Life-Saving Equipment Norway AS P.O Box 115 Tel: +47 37 05 85 00 4852 Færвик Fax: +47 37 05 85 01 NORWAY 24/7 Service: +47 37 05 63 33 Email: Viking-Norsafe@viking-life.com	
		Drawn by TOWU Check by MISO Appr. by WAGU Initial release date 22/11/2019	Client number
Project number		Project name	
Title E-60 DAVIT FOR JYN-65, PS		Material Number	
Drawing type GA		Tolerances ISO 2768-mK, ISO 13920-BF	
Drawing Number G-503166		Scale 1:50	
Revision 2		Sheet Size A3	
		Sheet No. 2/2	

This drawing is the sole property of VIKING Norsafe Life-Saving Equipment Norway AS. It must not be submitted to other parties nor used in any manner detrimental to our interests. It shall not be copied, reproduced, used for manufacturing or sale without the written consent of VIKING Norsafe Life-Saving Equipment Norway AS. All rights are reserved.